

1
Insert MEMo Chip.
Turn Analyzer On.

Inserte MEMo Chip.
Encienda el instru-
mento.

Introduza o MEMo
Chip. Ligue o
Analizador.

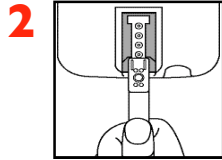

2
Insert the Test
Strip.

Inserte tira.

Introduza a Tira
de Teste.

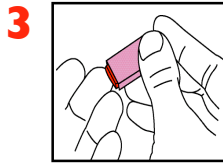

3
Stick finger.

Hurga su dedo.

Espete o dedo.

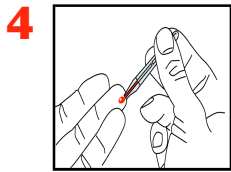

4
Collect sample.

Toma muestra.

Recolha a amostra.

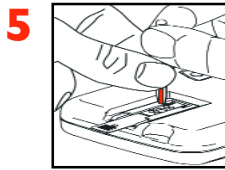

5
Apply blood to
strip.

Aplique muestra.

Aplique o sangue
na tira.

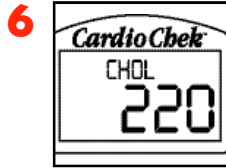

6
Read results.

Lea los
resultados.

Leia os
resultados.

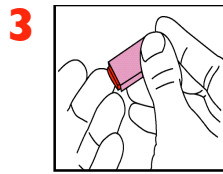
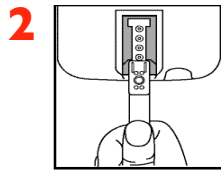
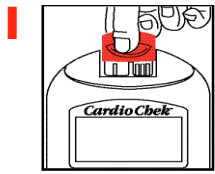

1 MEMO Chip einstecken.
Analysator einschalten.

2 Teststreifen ein-
stecken.

3 Finger einstecken.

Invoeren MEMO Chip.
Analyzer inschakelen.

Invoeren Test
Strip.

Vinger prikken.

Inserire MEMO Chip.
Accendere l'analizza-
tore.

Inserire la striscia
per il test.

Pungere il dito.

Insérez MEMO Chip.
Allumez l'appareil.

Allumez l'appareil. Piquez l'extrémité

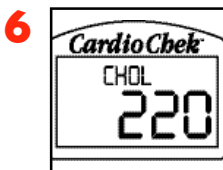
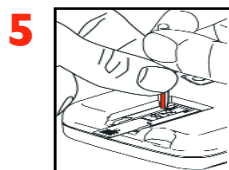
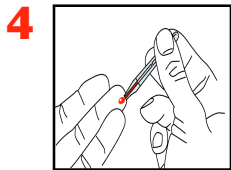

4 Probe sammeln.

5 Blut an Streifen
anbringen.

6 Ergebnisse able-
sen.

Monster afnemen.

Bloed op strip aan-
brengen.

Resultaten
aflezen.

Raccogliere il cam-
pione.

Applicare il sangue
sulla striscia.

Leggere i risul-
tati.

Prélever l'échantil-
lon.

Appliquer le sang à
la bande.

Lire les résultats.